

### Parts

Catania  
Ref: 10.647

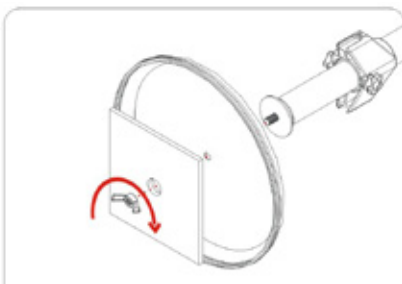

### Instructions



1. Joint the chassis and the stand column..

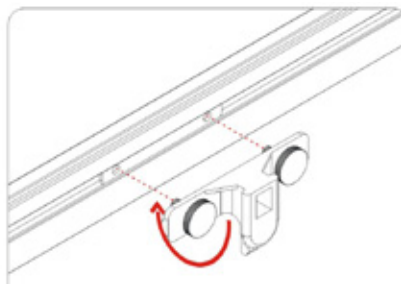

4. Joint the poster clip as the picture show..

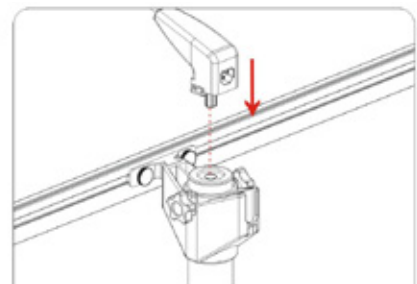

7. Put spotlight into the round hole on the top of stand column

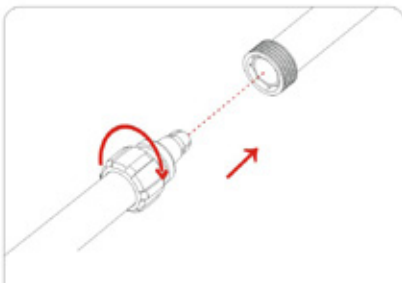

2. Joint the column and tighten the screw

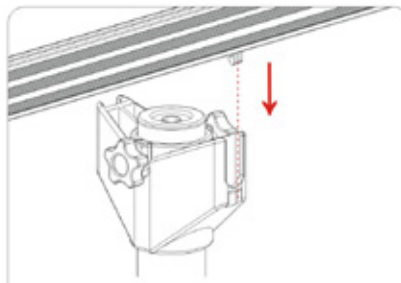

5. Joint the poster clip as the picture show..

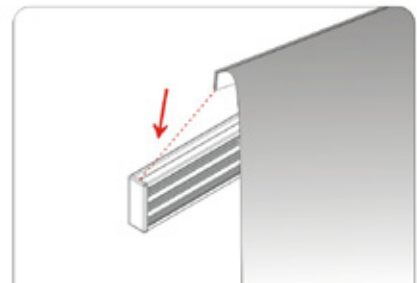

8. Install the graphic into the poster clip..

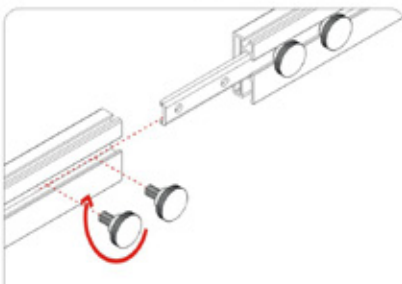

3. Joint the poster clip as the picture show.

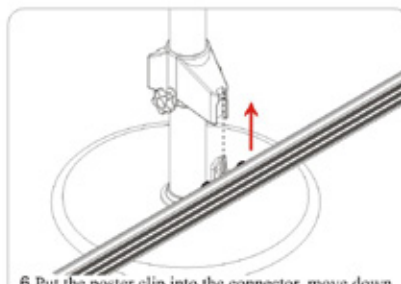

6. Put the poster clip into the connector, move down the connector and make the screw tight to fasten the clip



9. Finished.

**NOTE: CHECK THE SIZES OF IMPRESSION BEFORE THE MOUNT.**